

## Step-by-step guide

- Connect the camera to your computer
- Start the Zoom meeting.
- In a Zoom meeting, select Share Screen.

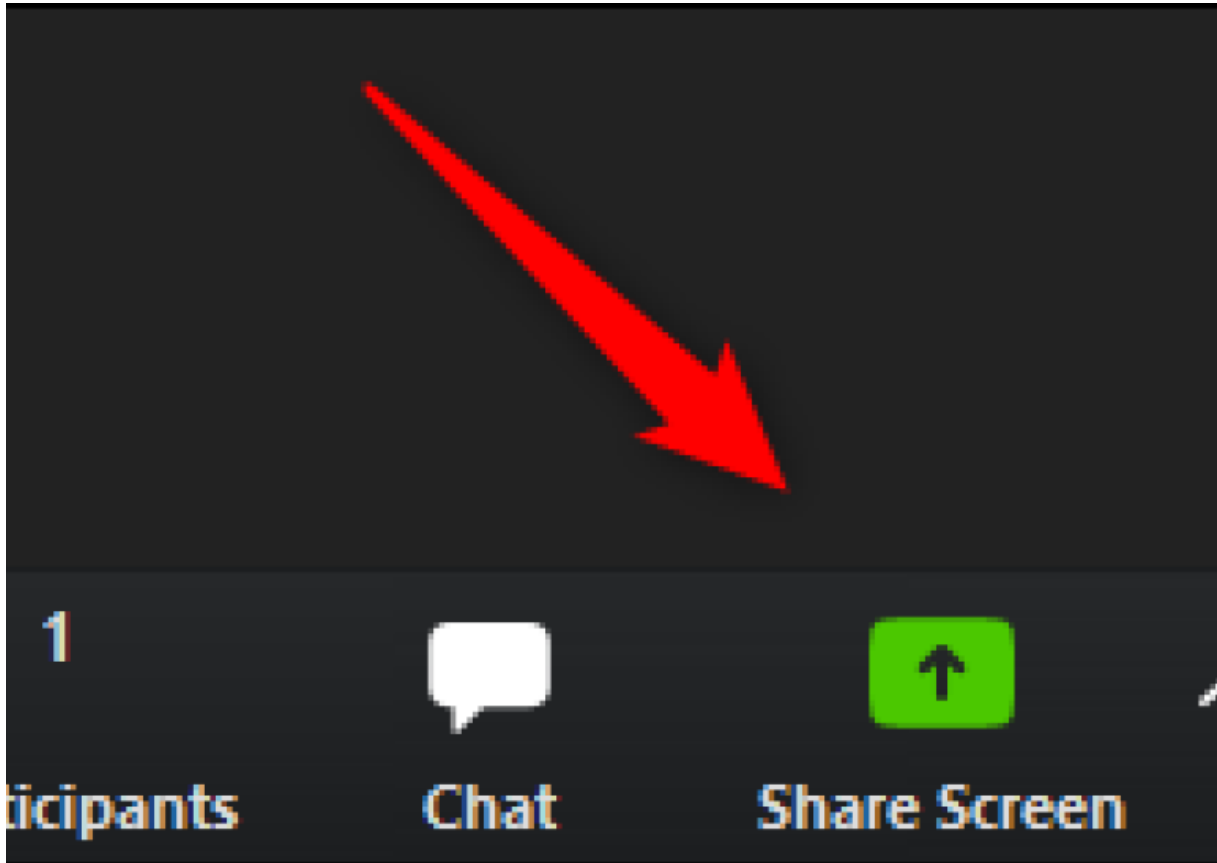

In a Zoom meeting, select Share Screen.

- Click the Advanced tab.

: a window or an application that you want to share

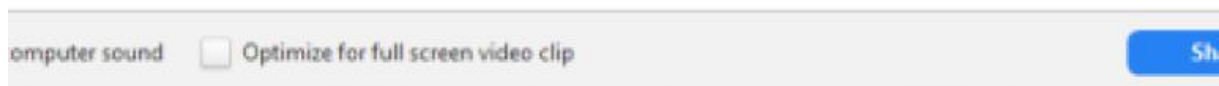
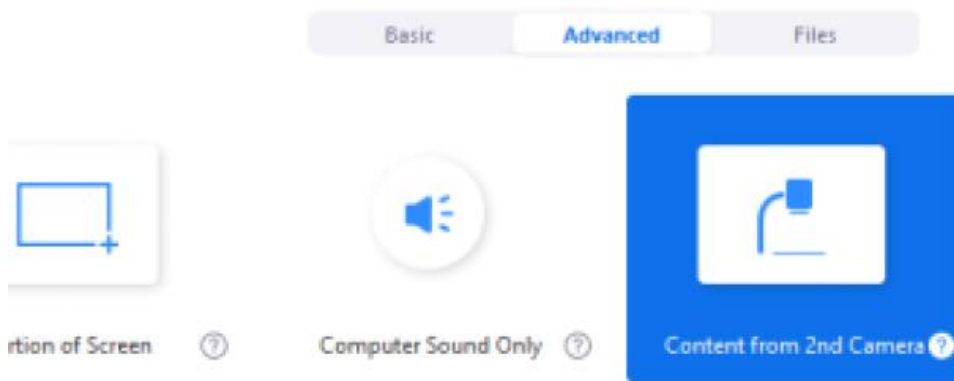

Click the Advanced tab. Click Content from 2nd Camera.

- Click Content from 2nd Camera.
- Click Share.
- If you need to choose a different camera, choose Switch Camera at the top left.

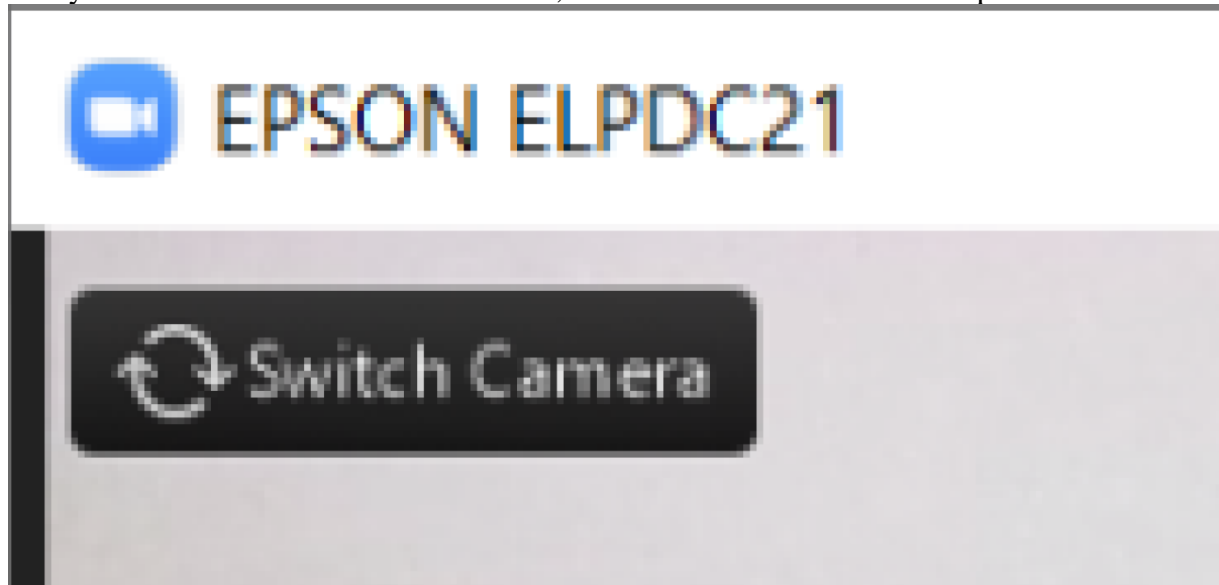

If you need to choose a different camera, choose Switch Camera at the top left.

- On ELPDC21 you can easily adjust brightness, zoom or focus by pressing the buttons.

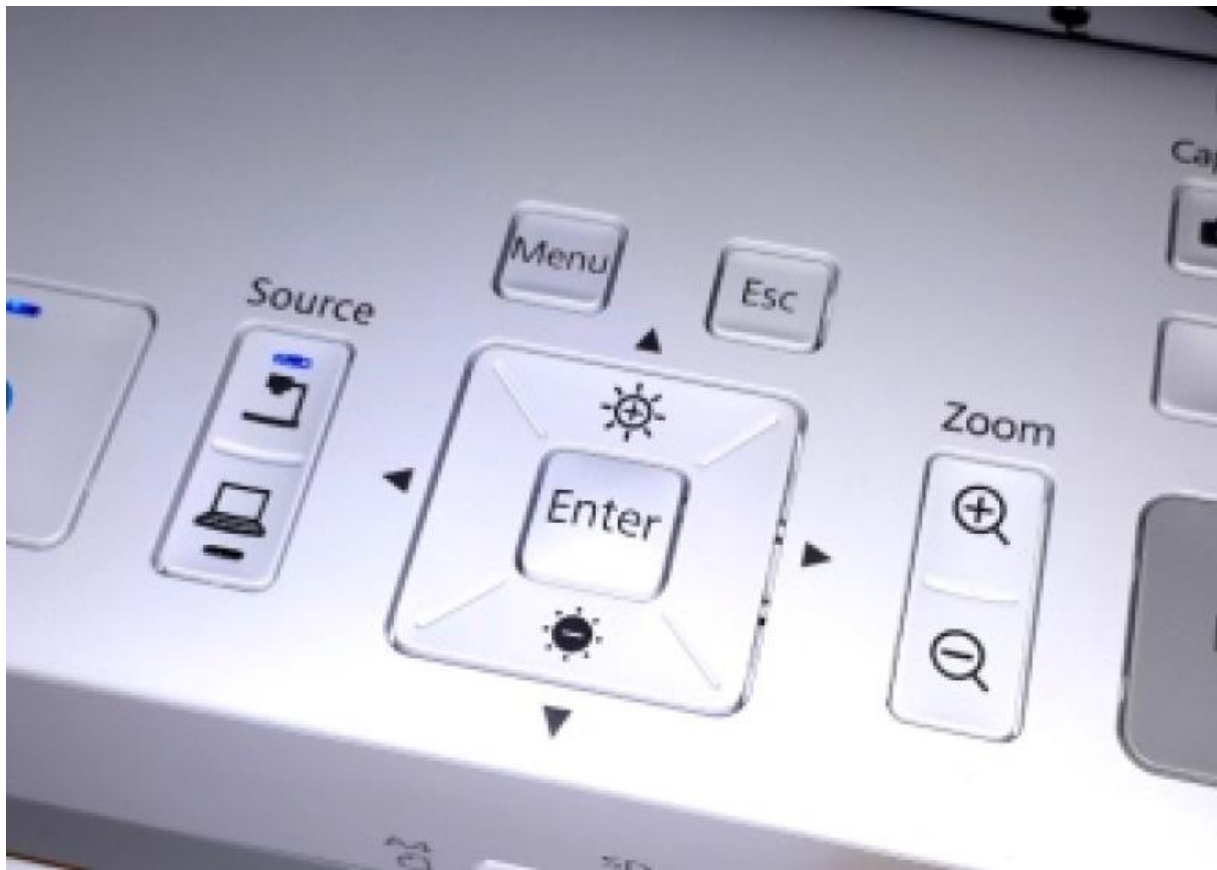

On ELPDC21 you can easily adjust brightness, zoom or focus by pressing the buttons.